

KENWORTH T-800 FENDER SHIELDS

P/N 28250 & 28256L

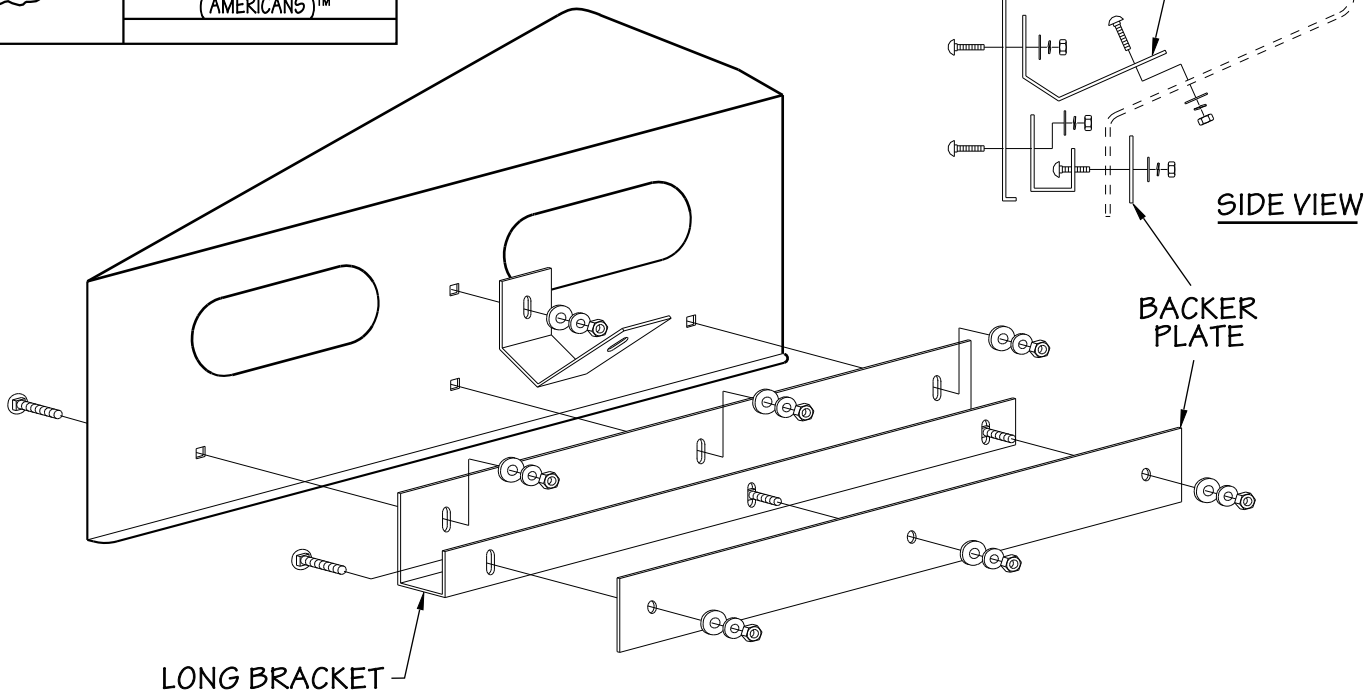
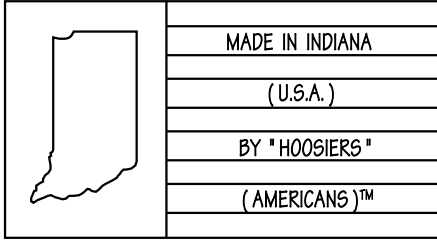

INSTRUCTIONS

1. BOLT THE LONG BRACKET TO THE FENDER SHIELD WITH THE "LONG LEG" AND SMALLER SLOTS AGAINST THE SHIELD AND TIGHTEN.
2. CAREFULLY POSITION THIS ASSEMBLY TO THE DESIRED LOCATION AND MARK THE THREE HOLES TO BE DRILLED IN THE FENDER.
(**NOTE!** THE SIDE TO SIDE LOCATION OF THESE HOLES ARE IMPORTANT AND THE VERTICAL SLOTS ALLOW FOR UP AND DOWN ADJUSTMENT AFTER INSTALLATION.)
3. DRILL THE THREE 5/16" DIAMETER HOLES IN THE FENDER AND MOUNT THE FENDER SHIELD ASSEMBLY TO A FINGER TIGHT CONDITION. (THE 2" WIDE BACKER PLATE GOES BEHIND THE FENDER).
4. BOLT THE UPPER BRACE ONTO THE SHIELD AND MARK THE HOLE TO BE DRILLED IN THE UPPER SLOPE OF THE FENDER.
5. DRILL THE 1/4" DIAMETER HOLE FOR THIS BRACE, REMOUNT THE COMPLETE ASSEMBLY AND TIGHTEN ALL BOLTS.
6. IF YOU HAVE PURCHASED A MODEL WITH LIGHTS, YOU ARE NOW READY TO INSTALL AND WIRE THE LIGHTS.

COPYRIGHT © 2007
RigSkirts LLC.

11/6/2007
28250INS



BY

