

QUARTER FENDER - STANDARD TUBE MOUNT

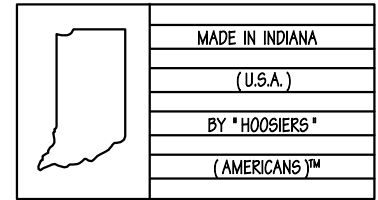
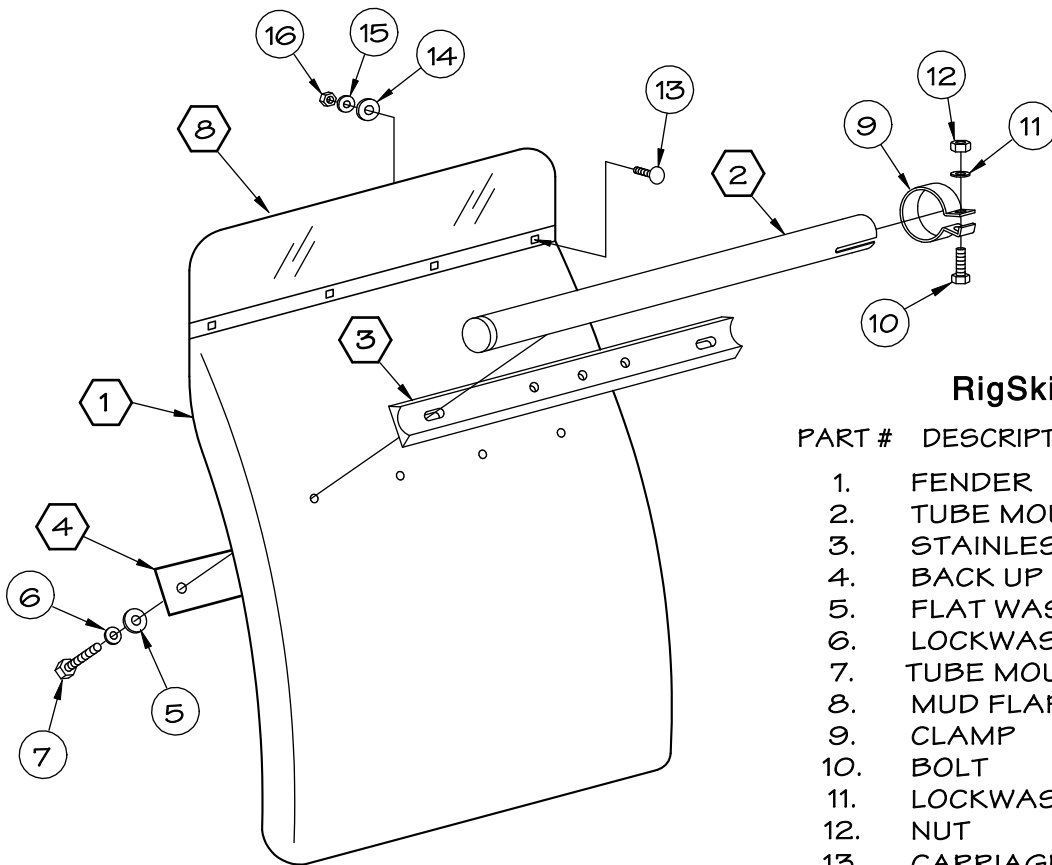

RigSkirts™ PARTS LIST

PART #	DESCRIPTION	SIZE
1.	FENDER	—
2.	TUBE MOUNT	2"
3.	STAINLESS SHIM	2-1/2" x 14-1/2"
4.	BACK UP PLATE	2-1/2" x 15"
5.	FLAT WASHER	5/16"
6.	LOCKWASHER	5/16"
7.	TUBE MOUNTING BOLT	5/16" x 1-1/2"
8.	MUD FLAP	6"
9.	CLAMP	2"
10.	BOLT	3/8" x 1-1/4"
11.	LOCKWASHER	3/8"
12.	NUT	3/8"
13.	CARRIAGE BOLTS	1/4" x 3/4"
14.	FLAT WASHERS	1/4"
15.	LOCKWASHERS	1/4"
16.	HEX NUTS	1/4"

⬡ DENOTES MAJOR PART-PACKED SEPARATELY

○ DENOTES SUB-ASSEMBLY PART-IN PARTS CONTAINER

COPYRIGHT © 2007
RigSkirts LLC.

INSTRUCTIONS

1. PRIOR TO MOUNTING THE TUBES ON THE FENDERS, POSITION THE TUBES ON THE FENDER TO INSURE A RIGHT HAND AND LEFT HAND MODEL. (ONE FOR EITHER SIDE OF THE TRUCK)
2. ATTACH MOUNTING TUBES (PART #2) TO THE FENDER. AFTER YOU HAVE THEM ASSEMBLED TO A "FINGERTIGHT" CONDITION, ALTERNATELY TIGHTEN EACH BOLT UNTIL THE LOCKWASHERS ARE COMPRESSED. **CAUTION:** OVER TIGHTENING MAY RESULT IN DAMAGE TO THE FENDER AND VOID THE WARRANTY.
3. MOUNT THE TOP FLAPS (PART #8) TO THE REAR OF THE FENDERS USING THE CARRIAGE BOLTS PROVIDED.
4. LOCATE THE TRUCK MOUNTS AND INSTALL. **NOTE!** TO LOCATE THE TRUCK MOUNTS, THE TOP OF THE FLAP SHOULD BE ONE TO TWO INCHES BELOW THE TOP OF THE FIFTH WHEEL IN A LEVEL POSITION.
5. PLACE THE TUBE CLAMP (PART #9) OVER THE MOUNTING TUBES (PART #2). SLIDE THE MOUNTING TUBES OVER THE TRUCK MOUNTS, POSITION THE FENDER OVER THE THE CENTER OF THE TIRES AND TIGHTEN THE CLAMPS.

11/6/2007
408100INS



BY

