

QUARTER FENDER - SHAPED MOUNT

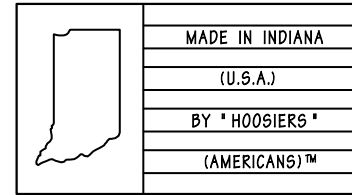
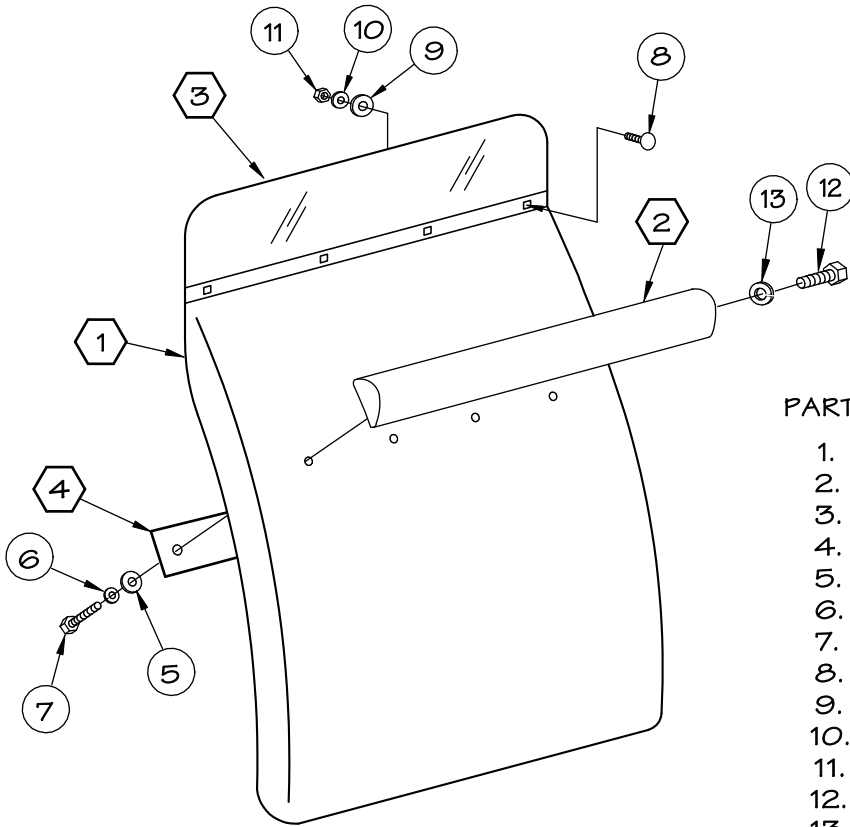

RigSkirts™ PARTS LIST

PART #	DESCRIPTION	SIZE
1.	FENDER	—
2.	SHAPED SUPER MOUNT™	—
3.	MUD FLAP	6"
4.	BACK UP PLATE	2-1/2" x 15"
5.	FLAT WASHER	5/16"
6.	LOCKWASHER	5/16"
7.	MOUNT BOLT	5/16" x 1-1/2"
8.	CARRIAGE BOLTS	1/4" x 3/4"
9.	FLAT WASHER	1/4"
10.	LOCKWASHER	1/4"
11.	HEX NUT	1/4"
12.	HEX BOLT	3/4"
13.	LOCKWASHER	3/4"

- ⬡ DENOTES MAJOR PART-PACKED SEPARATELY
- DENOTES SUB-ASSEMBLY PART-IN PARTS CONTAINER

COPYRIGHT © 2007
RigSkirts LLC.



BY

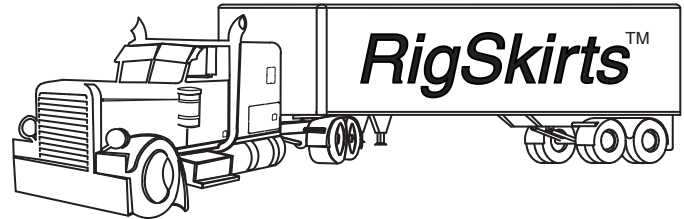

INSTRUCTIONS

- PRIOR TO MOUNTING THE SHAPED SUPER MOUNTS™ ON THE FENDERS, POSITION THE MOUNTS ON THE FENDERS TO INSURE A RIGHT HAND AND LEFT HAND MODEL. (ONE FOR EITHER SIDE OF THE TRUCK)
- ATTACH THE MOUNTS (PART #2) TO THE FENDER. AFTER YOU HAVE THEM ASSEMBLED TO A "FINGERTIGHT" CONDITION, ALTERNATELY TIGHTEN EACH BOLT UNTIL THE LOCKWASHERS ARE COMPRESSED. **CAUTION:** OVER TIGHTENING MAY RESULT IN DAMAGE TO THE FENDER AND VOID THE WARRANTY.
- MOUNT THE TOP FLAPS (PART #3) TO THE REAR OF THE FENDERS USING THE THE CARRIAGE BOLTS PROVIDED.
- PLACE THE FENDER IN THE DESIRED POSITION AND LOCATE THE HOLES TO BE DRILLED INTO THE FRAME. NOTE! FOR PROPER CLEARANCE, THE TOP OF THE MUD FLAP SHOULD BE ONE TO TWO INCHES BELOW THE TOP OF THE FIFTH WHEEL IN A LEVEL POSITION.
- CHECK THE FENDER FOR PROPER POSITIONING OVER THE TIRES AND TIGHTEN ALL BOLTS.