

SUPER MOUNT™ - REAR

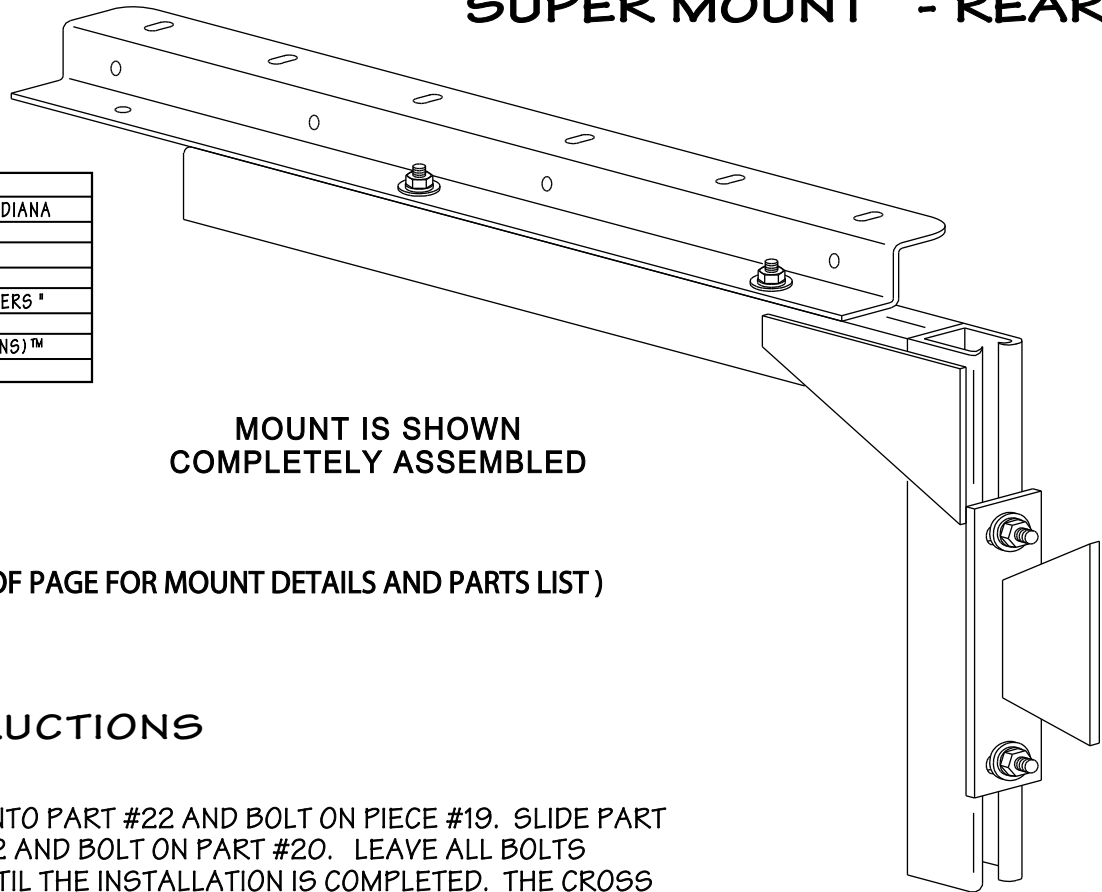
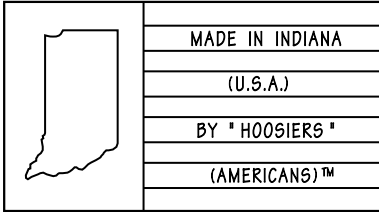

**MOUNT IS SHOWN
COMPLETELY ASSEMBLED**

(SEE BACK SIDE OF PAGE FOR MOUNT DETAILS AND PARTS LIST)

INSTRUCTIONS

1. SLIDE PART #23 INTO PART #22 AND BOLT ON PIECE #19. SLIDE PART #21 INTO PART #22 AND BOLT ON PART #20. LEAVE ALL BOLTS "FINGERTIGHT" UNTIL THE INSTALLATION IS COMPLETED. THE CROSS SECTION SHOWS THAT A MUD FLAP CAN BE USED IN CONJUNCTION WITH THIS MOUNT FOR HALF FENDER MOUNTING.
2. UTILIZING BOARDS OR SOME OTHER MEANS ON TOP OF THE TIRES, TEMPORARILY PROP THE FENDER TO THE DESIRED POSITION WITH THE AIR BAGS DEFLATED.
3. CAREFULLY MARK THE POSITION PART #20 IS TO BE WELDED TO THE FIFTH WHEEL MOUNTING ANGLE OR WHERE THE OPTIONAL PART #20T IS TO BE BOLTED ON TO THE FRAME. (SEE NOTE ON OPTIONAL MOUNT)
4. REMOVE THE FENDER FROM THE TRUCK. WELD THE "T" MOUNTS (PART #20) TO THE FIFTH WHEEL MOUNTING ANGLE. **NEVER WELD DIRECTLY TO THE TRUCK FRAME - FOLLOW THE MANUFACTURER'S INSTRUCTIONS.**
5. BOLT THE MOUNT ASSEMBLY BACK ONTO PART #20. PLACE THE FENDER BACK INTO POSITION AND MARK THE HOLES TO BE DRILLED IN THE FENDER. (NOTICE THAT PART #19 WILL SLIDE IN AND OUT TO PLACE THE FENDER DIRECTLY OVER THE CENTER OF THE TIRES).
6. REMOVE THE FENDER FROM THE TRUCK AND DRILL THE HOLES FOR THE MOUNT.
7. PLACE THE FENDER BACK ON THE TRUCK AND INSTALL ALL OF THE BOLTS.
8. YOU ARE NOW READY FOR FINAL ADJUSTMENT OF THE ENTIRE FENDER FOR HEIGHT, STRAIGHTNESS AND CENTER OVER WHEELS. SHIMMING OF THE BRACKETS MAY BE REQUIRED TO BRING THE FENDER INTO A STRAIGHT AND TRUE POSITION (BETWEEN PART #20 AND #21). MAKE SURE YOU HAVE THE PROPER CLEARANCE OVER THE TIRES AND THE TOP OF THE FENDERS ARE LOW ENOUGH TO CLEAR THE TRAILER. TIGHTEN ALL BOLTS.



BY



SUPER MOUNT™ - REAR

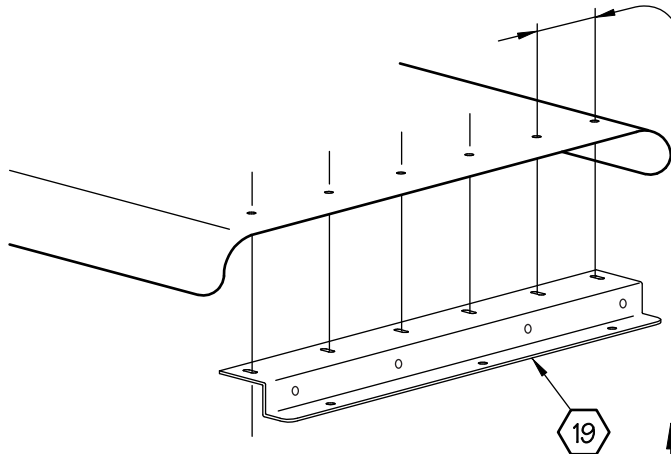

NOTE!

FENDER MOUNT BOLTS ARE 4" APART. IF YOU ARE USING THIS MOUNT AS A MID-MOUNT ON TANDEM FENDERS, WE RECOMMEND NOT USING BOLTS IN THESE LOCATIONS IN ORDER TO ALLOW FENDER TO FLEX WITH THE TRUCK FRAME.

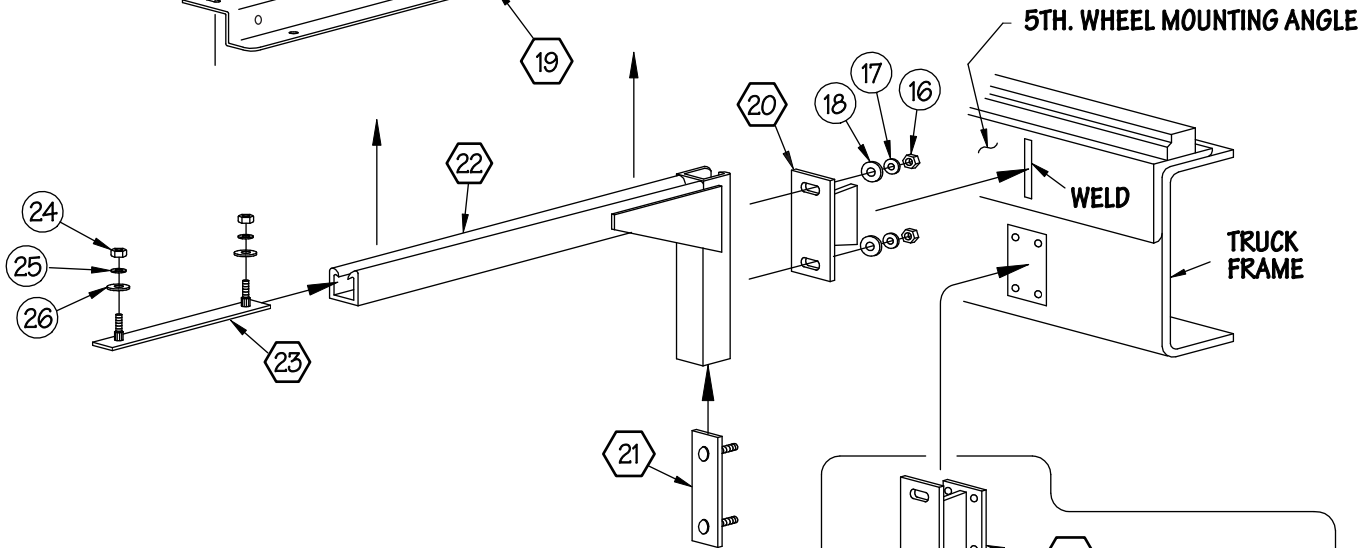

OPTIONAL BOLT ON MOUNT

THIS MOUNT **MUST** BE USED IF THE 5TH. WHEEL MOUNTING ANGLE IS ALUMINUM

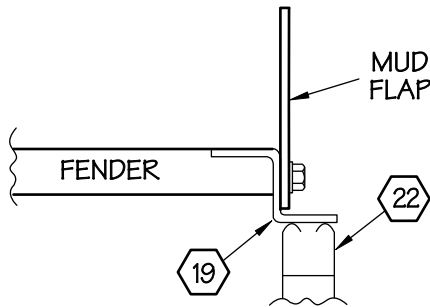
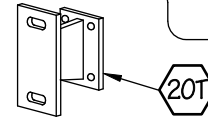

CROSS SECTION

MUD FLAPS MAY BE USED AS SHOWN FOR HALF FENDER MOUNTING

⬡ DENOTES MAJOR PART (PACKED SEPARATELY)

○ DENOTES SUB-ASSEMBLY (IN PARTS CONTAINER)

PARTS LIST

16	HEX NUT 1/2"	17	LOCK WASHER 1/2"	18	FLAT WASHER 1/2"
19	FENDER SUPPORT "Z"	20	"T" TRUCK MOUNT	20T	OPTIONAL BOLT-ON MOUNT
21	VERTICAL MOUNT BAR	22	"L" FENDER SUPPORT	23	HORIZONTAL MOUNT BAR
24	HEX NUT 5/16"	25	LOCKWASHER 5/16"	26	FLAT WASHER 5/16"