

## FREIGHTLINER AIR CLEANER LIGHT PANELS ( REAR - CENTER MOUNT )

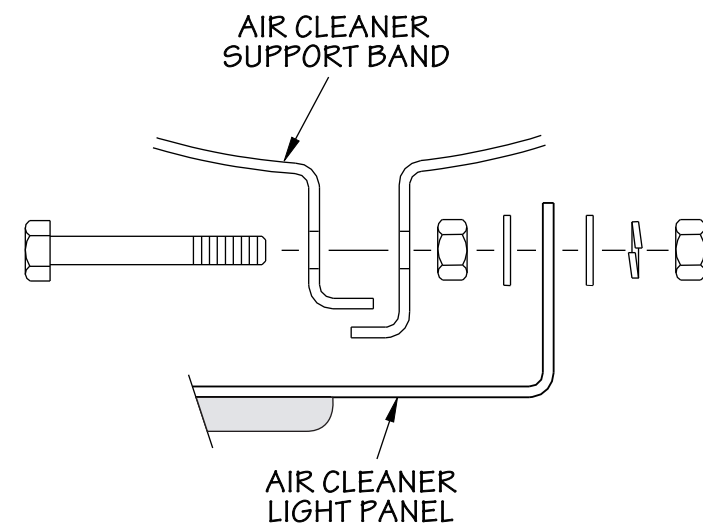

**ILLUSTRATION #2**

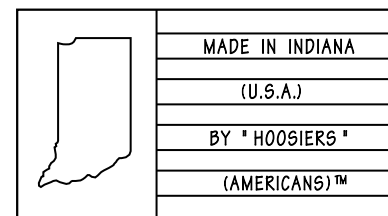
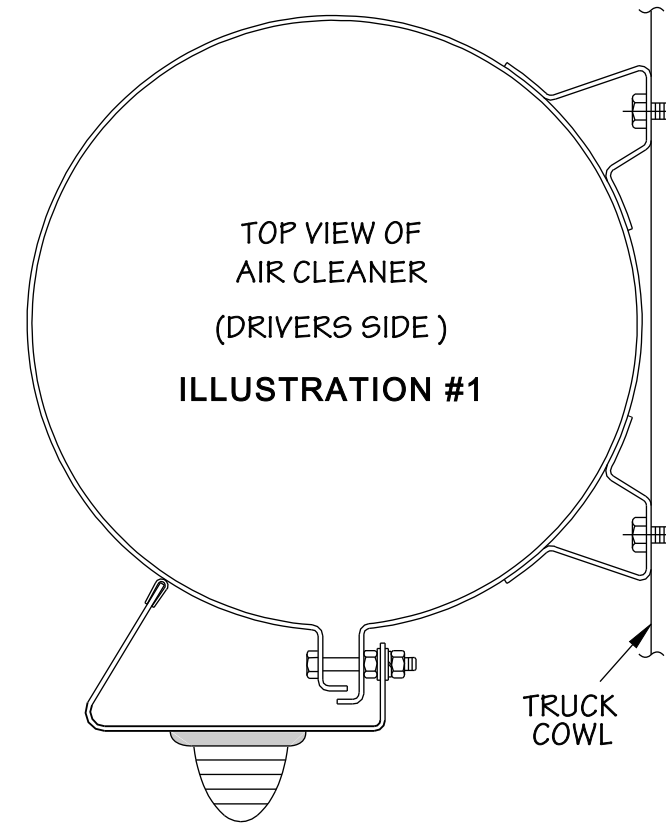

### INSTRUCTIONS

**CAUTION!** PAY PARTICULAR ATTENTION TO ILLUSTRATION #2 AND OBSERVE THE LOCATION OF THE BOLT, NUTS, WASHERS AND LOCKWASHER WHILE PERFORMING STEPS #1, 2 AND 3.

1. REMOVE THE BOLTS FROM THE AIR CLEANER SUPPORT BANDS AND REPLACE WITH THE BOLTS SUPPLIED IN THE KIT. TIGHTEN THE BOLTS UTILIZING ONE NUT ONLY.

**NOTE!** REPLACE AND THEN TIGHTEN ONE BOLT AT A TIME TO PROVIDE SUPPORT FOR THE AIR CLEANER DURING THIS OPERATION.

2. PLACE ONE FLAT WASHER OVER THE BOLT ENDS AND AGAINST THE NUTS YOU HAVE JUST INSTALLED.
3. SLIDE THE LIGHT PANELS OVER THE PROTRUDING BOLT ENDS, ADD ONE WASHER, LOCKWASHER AND NUT TO EACH BOLT, **IN THAT ORDER**, TO THE OUTSIDE OF THE AIR CLEANER PANEL.
4. TIGHTEN THE NUTS AGAINST THE LIGHT PANEL BEING CAREFULL NOT TO OVERTIGHTEN.
5. YOU ARE NOW READY TO INSTALL AND WIRE THE LIGHTS.



BY

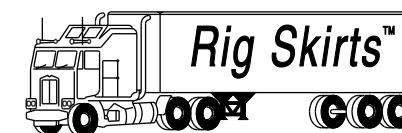

COPYRIGHT © 1996  
ACCURATE INDUSTRIES, INC.

FA0030INS 8-23-00